

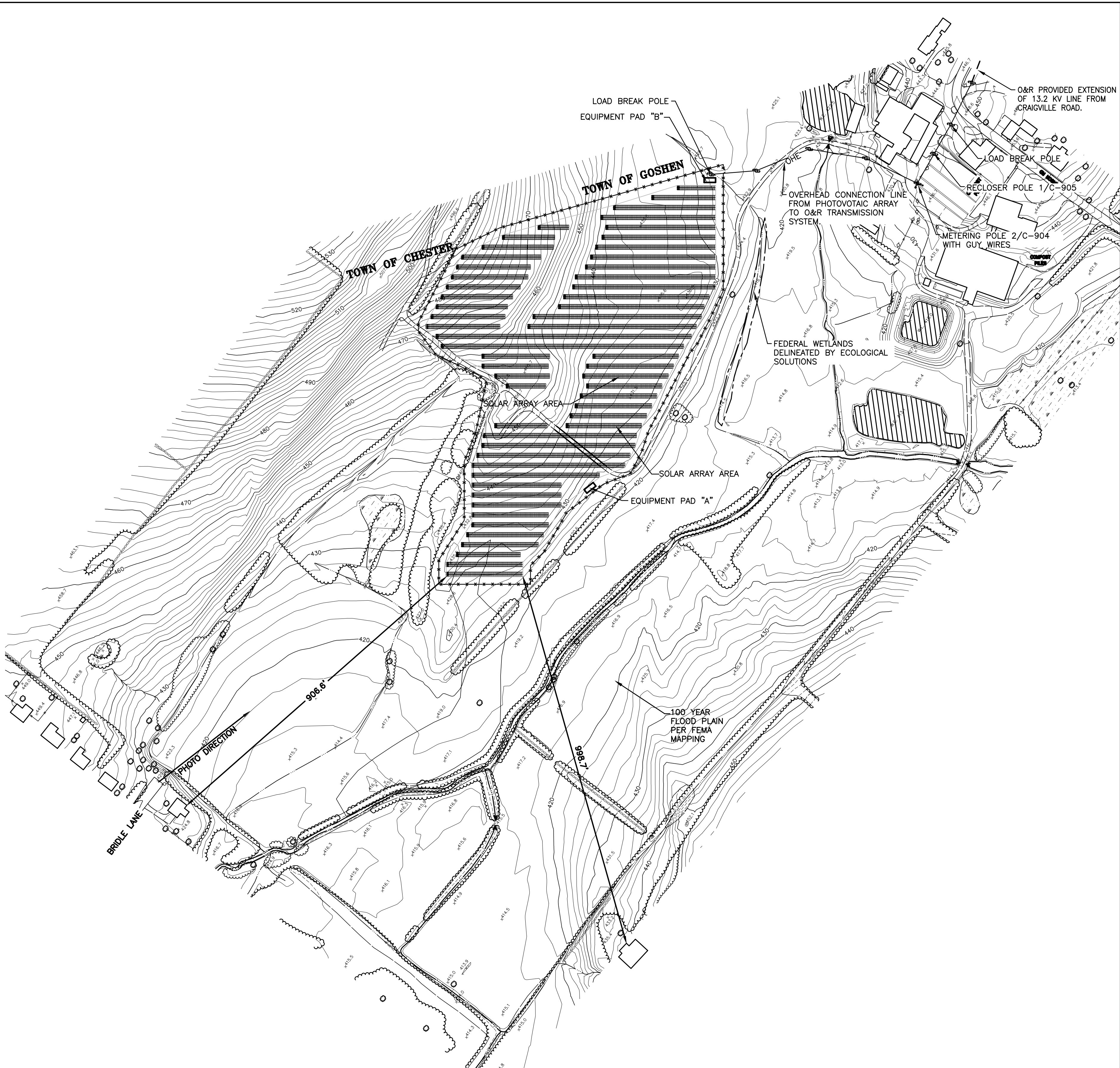

1 PREVIOUS SOLAR ARRAY LAYOUT (JAN 5, 2016 PUBLIC HEARING)
1"=150'±



2 PROPOSED SOLAR ARRAY LAYOUT (SCHEDULED MARCH 2, 2016 PUBLIC HEARING)
1"=150'±



3 PHOTO VIEW FROM END OF BRIDLE LANE
N.T.S.



4 ENLARGED PORTION OF VIEW FROM BRIDLE LANE
N.T.S.

NOTE:
UPON DECOMMISSIONING OF THE SOLAR ARRAY, THE ARRAY OPERATOR SHALL REMOVE THE ARRAY, RACKING, INVERTERS, POLES, UNDERGROUND AND OVERHEAD WIRING AND ALL ASSOCIATED IMPROVEMENTS AND SHALL RETURN THE LAND TO ITS PRE-CONSTRUCTION STATE.

TOWN OF CHESTER PLANNING BOARD APPROVAL

REV #	DATE	REMARKS	ISSUE #	DATE	ISSUED FOR:
1"=150'±					
REFERENCE SCALE					
UNAUTHORIZED ALTERATION OR ADDITION TO A PLAN BEARING A LICENSED PROFESSIONAL ENGINEER'S SEAL IS A VIOLATION OF SECTION 7209, SUB-DIVISION 2 OF THE N.Y. STATE EDUCATION LAW.					
FELLENZER III ENGINEERING LLP www.fellp.com					
22 Mulberry St., Suite 2A, Middletown, NY 10940 1-845-343-1481 fx 845-343-4986					
181 Church St., Suite 100, Poughkeepsie, NY 12601 1-845-454-9704 fx 855-320-8735					
STAMP:					
PROJECT TITLE: JOHNSON FARM PHOTOVOLTAIC ARRAY 121 JOHNSON ROAD, CHESTER, NY 10918					
DRAWING TITLE: SOLAR ARRAY OPTIONS					
DESIGNED BY: RDF	DRAWN BY: SAR	APPROVED BY P.E.: ACL	APPROVED BY P.E.: MDF	DRAWING #: C-101	
DATE: 09/15/15	SCALE: AS SHOWN	FE PROJECT #: 15-255	PAGE 2 OF 10		