

STABILIZED CONSTRUCTION ENTRANCE

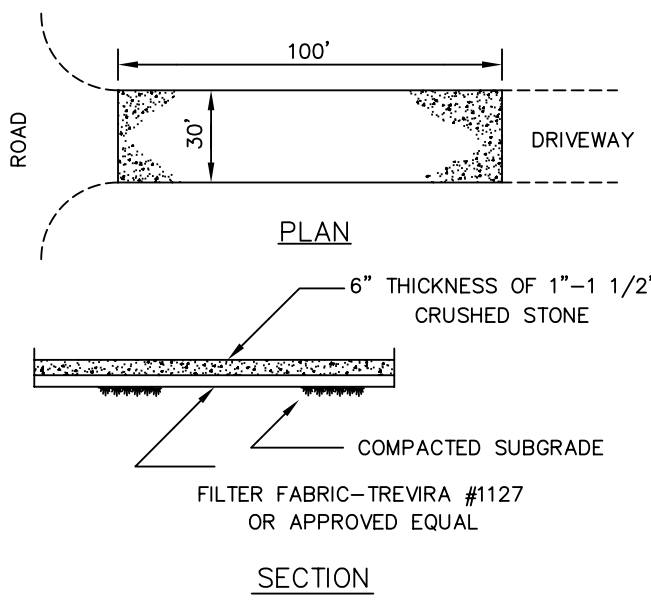

NOTE: ENTRANCE SHALL BE MAINTAINED AS CONDITIONS DEMAND TO PREVENT TRACKING OF SEDIMENT ONTO PUBLIC RIGHT OF WAYS

ALL SEDIMENTATION STRUCTURES WILL BE INSPECTED AND MAINTAINED ON A REGULAR BASIS. A CRUSHED STONE, VEHICLE WHEEL-CLEANING BLANKET WILL BE INSTALLED WHENEVER A CONSTRUCTION ACCESS DRIVE INTERSECTS ANY PAVED ROADWAY. SAID BLANKET WILL BE COMPOSED OF 6" DEPTH OF 1"-1 1/2" CRUSHED STONE, WILL BE AT LEAST 30 X 100' AND SHOULD BE PLACED ON COMPACTED SUBGRADE AND SHALL BE MAINTAINED.

PAVED ROADWAYS MUST BE KEPT CLEAN AT ALL TIMES.

ALL SOIL EROSION AND SEDIMENT CONTROL STRUCTURES MUST BE DETAILED ON THE PLAN.

SEQUENCE OF CONSTRUCTION:

1. PROVIDE STABILIZED 24' X 50' CONSTRUCTION PAD ENTRANCE AT LOCATION SHOWN.
2. CONSTRUCT SEDIMENT BARRIERS AS SHOWN AND/OR AS REQUIRED.
3. BEGIN BUILDING CONSTRUCTION.
4. INSTALL SITE IMPROVEMENTS SUCH AS WALLS AND NEW DRIVEWAY BASE AS DEVELOPMENT PROCEEDS, SPREAD TOP SOIL (MINIMUM 4") AND SEED, STABILIZE ALL OPEN AREAS WITH SEED AND MULCHING REQUIREMENTS.
5. AFTER PERMANENT PLANTING AND SEED HAVE BECOME ESTABLISHED, REMOVE SEDIMENT BARRIERS AND PERMANENTLY SEED DISTURBED AREAS, DRIVEWAY PAVEMENT CAN BE INSTALLED WHEN REQUIRED.

MAINTENANCE AND PROTECTION OF TRAFFIC:

WORK IS TO BE PERFORMED IN ACCORDANCE WITH ORANGE COUNTY REQUIREMENTS. THE FOLLOWING SIGNS ARE REQUIRED TO BE PLACED IN EACH DIRECTION TO PERFORM THE WORK PER THE APPROVED PLANS: ROAD WORK 1500 FT., ROAD WORK 1000 FT., ROAD WORK 500 FT., ONE LANE ROAD AHEAD, FLAGGER SYMBOL ON EACH APPROACH WHEN TAKING A TRAVEL LANE. WHEN WORK IS PERFORMED ON THE SHOULDER THE FOLLOWING SIGNS ARE REQUIRED: ROAD WORK 1500 FT., ROAD WORK 1000 FT., ROAD WORK 500 FT., NO SHOULDER FLAGGER SYMBOLS ARE REQUIRED TO BE AVAILABLE FOR A NO SHOULDER WORK ZONE IN CASE FLAGGERS ARE USED TO DIRECT TRAFFIC.

ALL MAINTENANCE AND PROTECTION OF TRAFFIC CONSTRUCTION SIGNAGE SHALL BE INSTALLED AND IN PLACE PRIOR ANY WORK STARTING. ALL CONSTRUCTION SIGNAGE IS REQUIRED TO MEET THE REQUIREMENTS AS PER THE "NATIONAL MANUAL DEVICES FOR STREETS AND HIGHWAYS" AND NYS SUPPLEMENT LATEST EDITION AND REVISIONS. THE CONSTRUCTION SIGNAGE SHALL BE INSTALLED ON PERMANENTLY POSTS OR ON WINDMASTERS AND COVERED AND UNCOVERED ON A DAILY BASIS. THE CONTRACTOR MUST HAVE ALL THE NECESSARY CONSTRUCTION SIGNS TO PERFORM THE WORK SAFELY. I.E. ADDITIONAL SIGNAGE: ONE LANE ROAD AHEAD, FLAGGER SYMBOL, IF A LANE HAS TO BE CLOSED TO PERFORM WORK.

ALL CONSTRUCTION SIGNAGE IS REQUIRED TO BE 730-05-02-ASTM TYPE III (CLASS B) AS PER NYS STANDARD SPECIFICATIONS: CONSTRUCTION AND MATERIALS. HI-INTENSITY REFLECTIVE SHEETING OFTEN REFERRED TO AS HIGH INTENSITY. IT IS RECOMMENDED FOR HIGHWAY SIGNS, CONSTRUCTION SIGNS, DELINEATORS, AND OTHER WORK ZONE DEVICES.

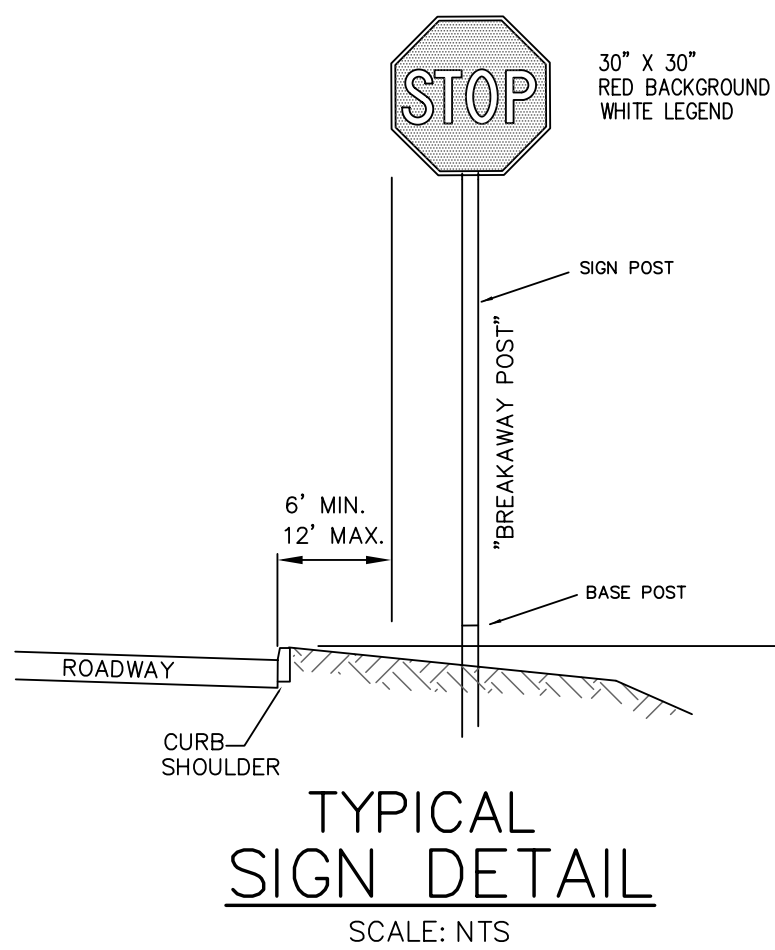

NOTES:

STOP SIGN: 30"x30" OR EQUAL; HI INTENSITY PRISMATIC GRADE
BASE POST: LENGTH 3'-6"; HOT DIPPED GALVANIZED; 4LB/FT STRENGTH
(SHORT POST PROJECTION ABOVE FINISHED GRADE IS TO BE NOT MORE THAN 4")
SIGN POST: LENGTH 10'-0"; HOT DIPPED GALVANIZED; 4 LB/FT STRENGTH
ATTACHED TO BASE POST IS (2) 3"-0"x3" WIDE; RED HI INTENSITY PRISMATIC GRADE
SIGN BOLTS: HOT DIPPED GALVANIZED GRADE 5
BREAKAWAY BOLTS: ALUMINUM

STRIPING:

REFLECTORIZED PAVEMENT MARKING PAINTS SHALL BE SELECTED FROM THE NYS DOT APPROVED LIST OF WHITE AND YELLOW REFLECTORIZED PAVEMENT MARKING PAINTS. IMMEDIATELY FOLLOWING PAINT APPLICATION, REFLECTIVE GLASS BEADS SHALL BE UNIFORMLY APPLIED AT A RATE OF 6 lb/gal OF PAINT. THE APPLIED PAVEMENT MARKINGS SHALL HAVE CLEAN-CUT EDGES AND TRUE AND SMOOTH ALIGNMENT. STOP BAR WIDTH IS 1'-6". SEE SECTION 640 REFLECTORIZED PAVEMENT MARKING PAINTS OF NYS DOT STANDARD SPECIFICATIONS FOR ALL REQUIREMENTS.

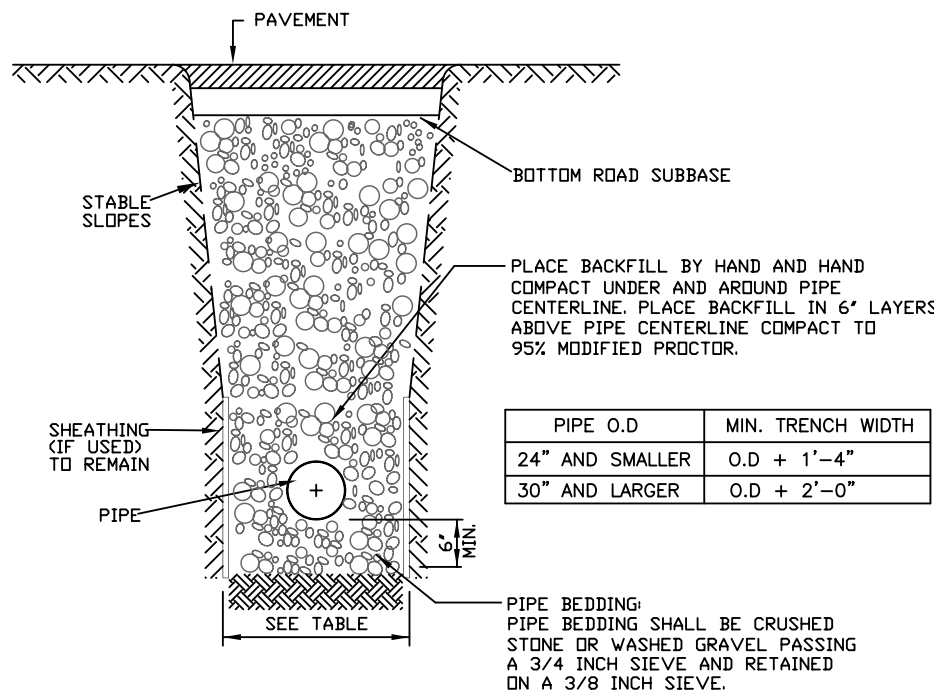

TYPICAL STORM DRAIN TRENCH BACKFILL DETAIL

NTS

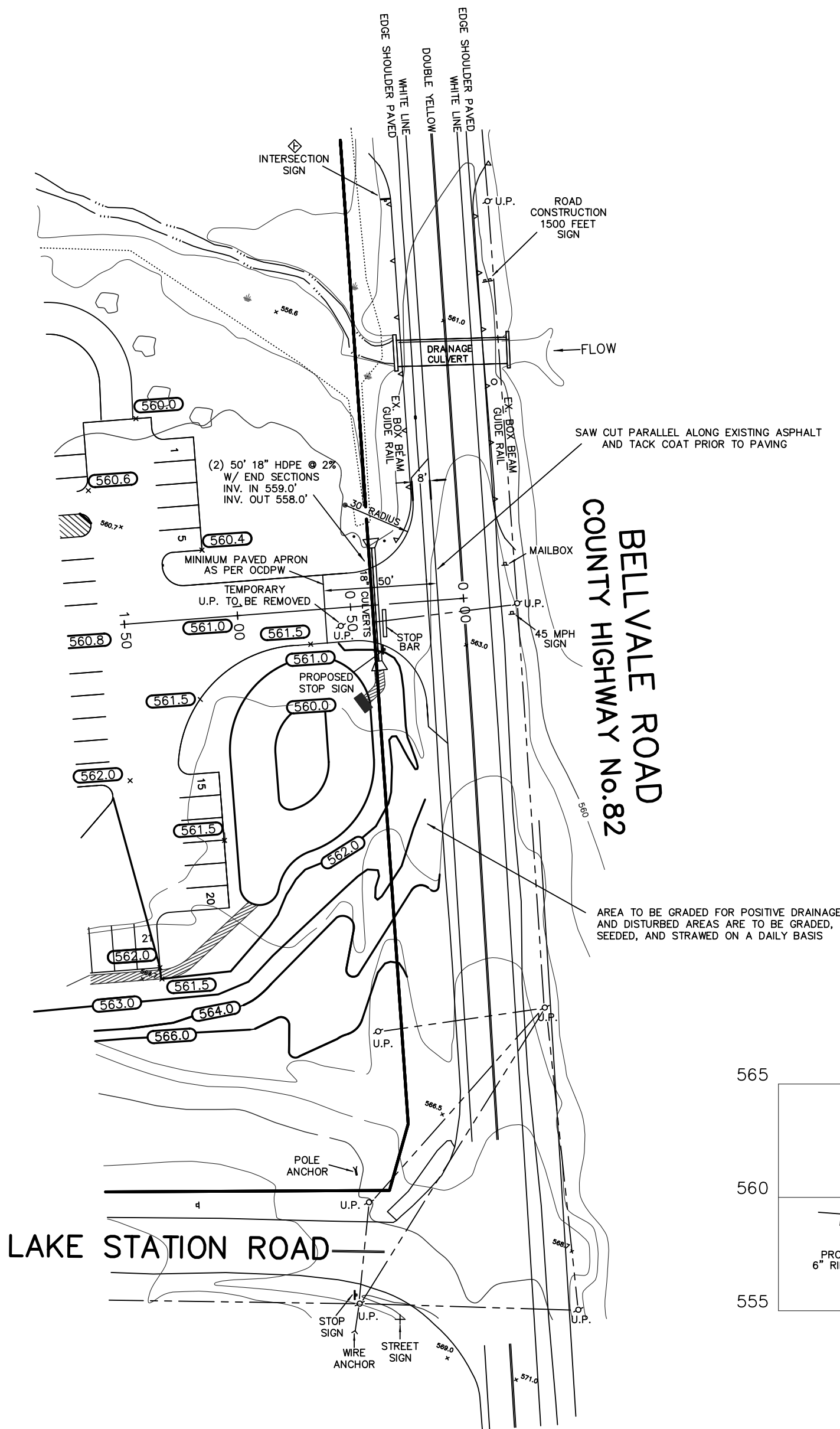

LAKE STATION ROAD

BELLVALE ROAD
COUNTY HIGHWAY No.82

LEGEND:

- UTILITY POLE
- UTILITY WIRES
- EXISTING CONTOURS
- PROPOSED CONTOURS
- EX. GUIDE RAIL

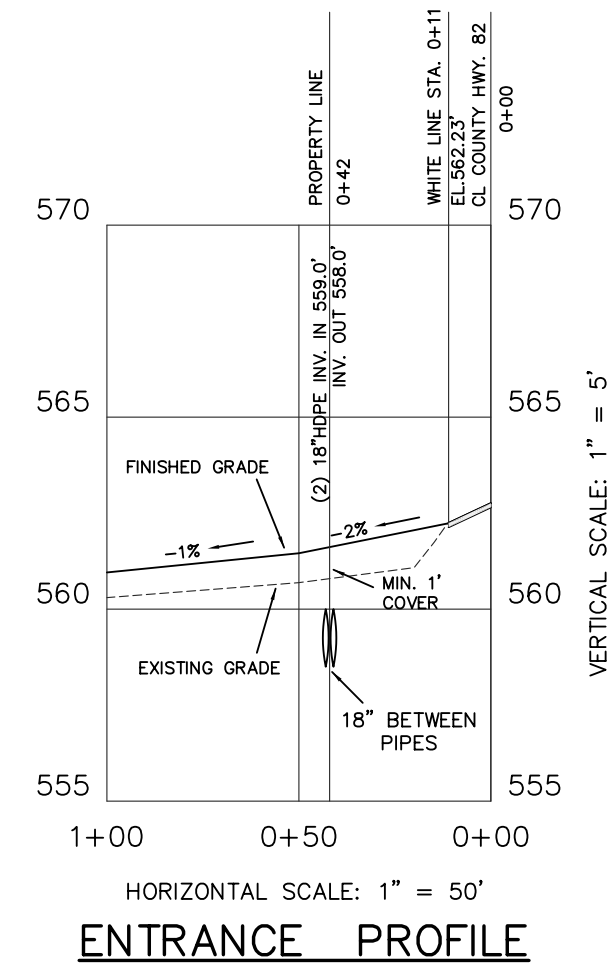

ENTRANCE PROFILE

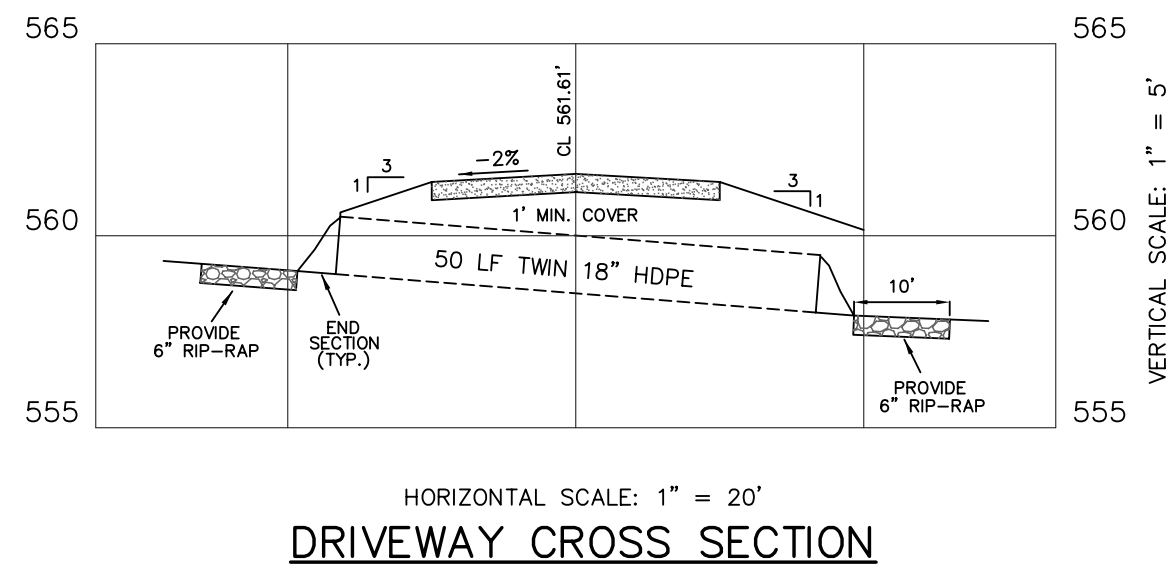

NOTE: TRANSITION ROAD CROWN FROM PROPERTY LINE TO STATION 1+0 ON SOUTH SIDE.

TYPICAL COMMERCIAL DRIVEWAY DETAIL

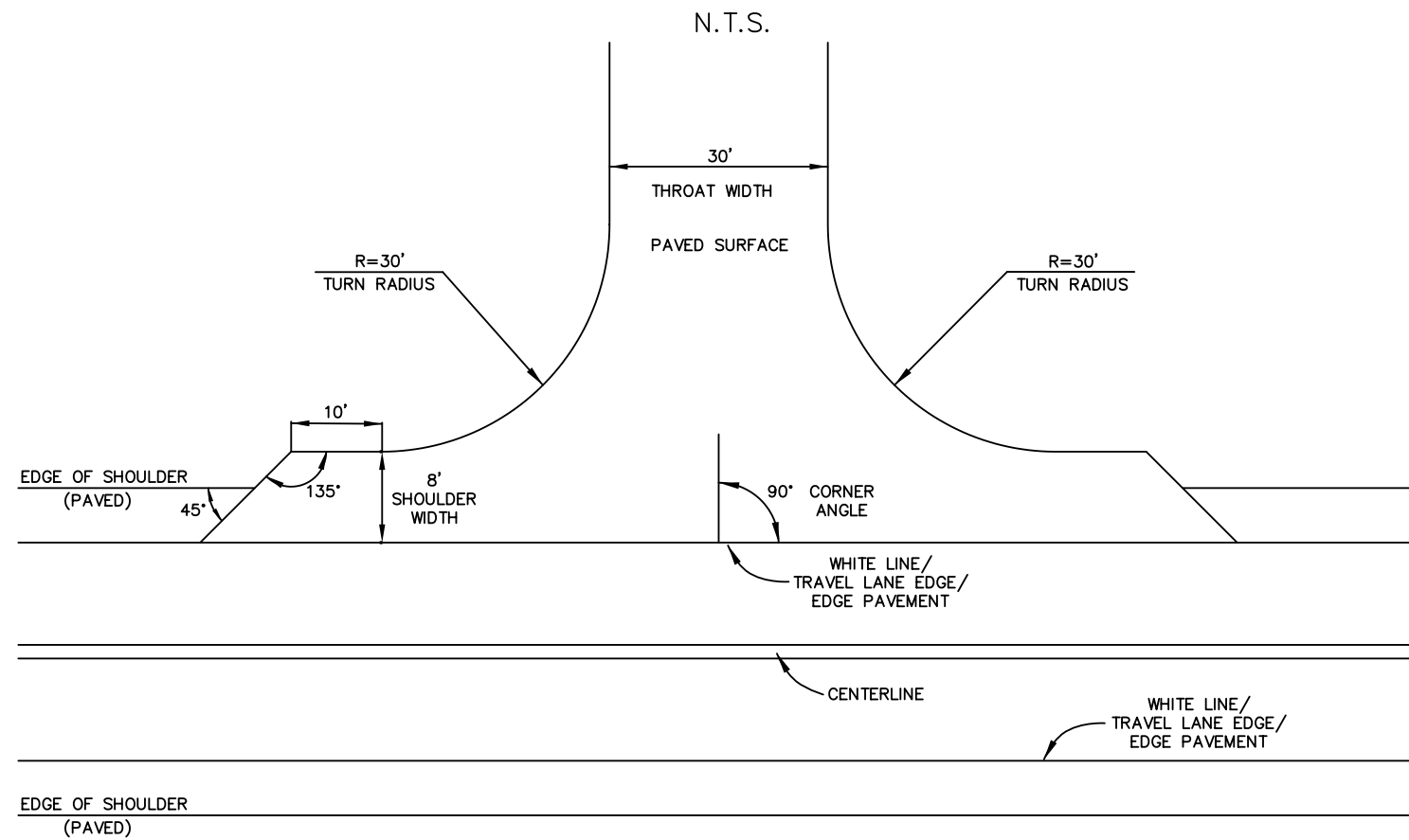

DRIVEWAY FILL - CROSS SECTION

NOTES:
ALL EDGES OF EXISTING ASPHALT ARE REQUIRED TO BE SWEPT AND TACK COATED PRIOR TO PAVING.
ALL ASPHALT IS REQUIRED TO BE SAW CUT PARALLEL OR PERPENDICULAR TO THE TRENCH OR TO THE EXISTING ASPHALT.
ALL ASPHALT JOINTS OF THE DRIVEWAY OR UTILITY CUT ARE REQUIRED TO BE CRACK SEALED UPON COMPLETING FINAL PAVING.

GENERAL NOTES:

1. CONTRACTOR SHALL BE RESPONSIBLE FOR THE REMOVAL AND REPLACEMENT OF SIGNS, GUIDE RAILS, GUIDE POSTS, CULVERT PIPES, MAILBOXES, HEADWALLS, ETC. WHICH MUST BE REMOVED FOR CONSTRUCTION. CONTRACTOR SHALL REINSTALL ANY REMOVED ITEMS ON A DAILY BASIS. ANY ITEMS DAMAGED BY REMOVAL OR REINSTALLATION SHALL BE REPLACED AND REINSTALLED BY THE CONTRACTOR WITH A NEW ITEM.
2. NO PLANTINGS (SHRUBS/TREES) OR LANDSCAPING FEATURES (STONE PILLARS, STONE WALLS, SIGNS, ETC.) SHALL BE PLACED WITHIN THE COUNTY RIGHT OF WAY.
3. ALL WORK IS TO BE PERFORMED IN ACCORDANCE WITH ORANGE COUNTY REQUIREMENTS.
4. ALL MAINTENANCE AND PROTECTION OF TRAFFIC CONSTRUCTION SIGNAGE SHALL BE INSTALLED AND IN PLACE PRIOR TO ANY WORK STARTING. SIGNAGE IS REQUIRED TO BE 730-05-02-ASTM TYPE III (CLASS B) AS PER NYS STANDARD SPECIFICATIONS.

COUNTY HIGHWAY ENTRANCE DESIGN

FOR
BAZS

TOWN OF CHESTER
SCALE: 1"=50'

OCTOBER 16, 2014
REVISED: DECEMBER 3, 2014
REVISED: FEBRUARY 3, 2015

ORANGE COUNTY, N.Y.
AREA= 7.30 ACRES



JOSEPH GOTTLIEB, P.E., P.C.
CONSULTING ENGINEER

P.O. BOX 76
MONTICELLO
NEW YORK 12071



JAMES A. DILLIN, PLS
PROFESSIONAL LAND SURVEYOR
GOSHEN, NEW YORK

NOTE: NO SITE PREPARATION OR CONSTRUCTION, INCLUDING UTILITY CONNECTIONS SHALL COMMENCE UNTIL A VALID HIGHWAY WORK PERMIT HAS BEEN SECURED FROM THE ORANGE COUNTY DEPARTMENT OF PUBLIC WORKS UNDER SECTION 136 OF THE HIGHWAY LAW.

UNAUTHORIZED ALTERATION OF THIS DOCUMENT, IN ANY WAY, CONSTITUTES A VIOLATION OF THE STATE OF NEW YORK EDUCATION LAW SECTION 7209 (2).