

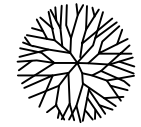

PLANTINGS:

SYMBOL	NAME	QUANTITY	MIN. SIZE
	MAPLE TREE	4	2 1/2" - 3" CAL.
	PINE	13	2 1/2" - 3" CAL.
	JUNIPER	6	2 GAL. CONTAINER



SILT FENCE DETAILS

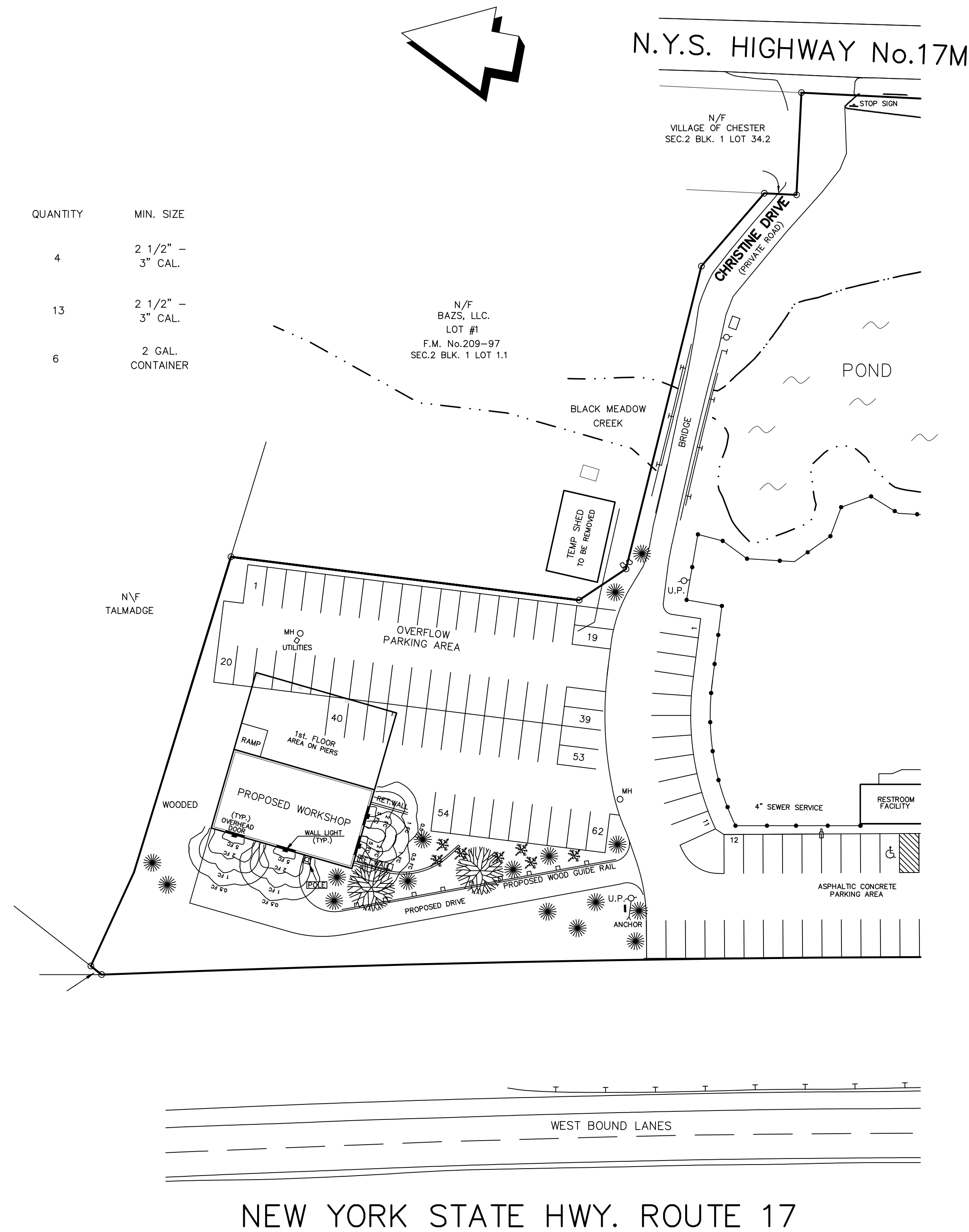
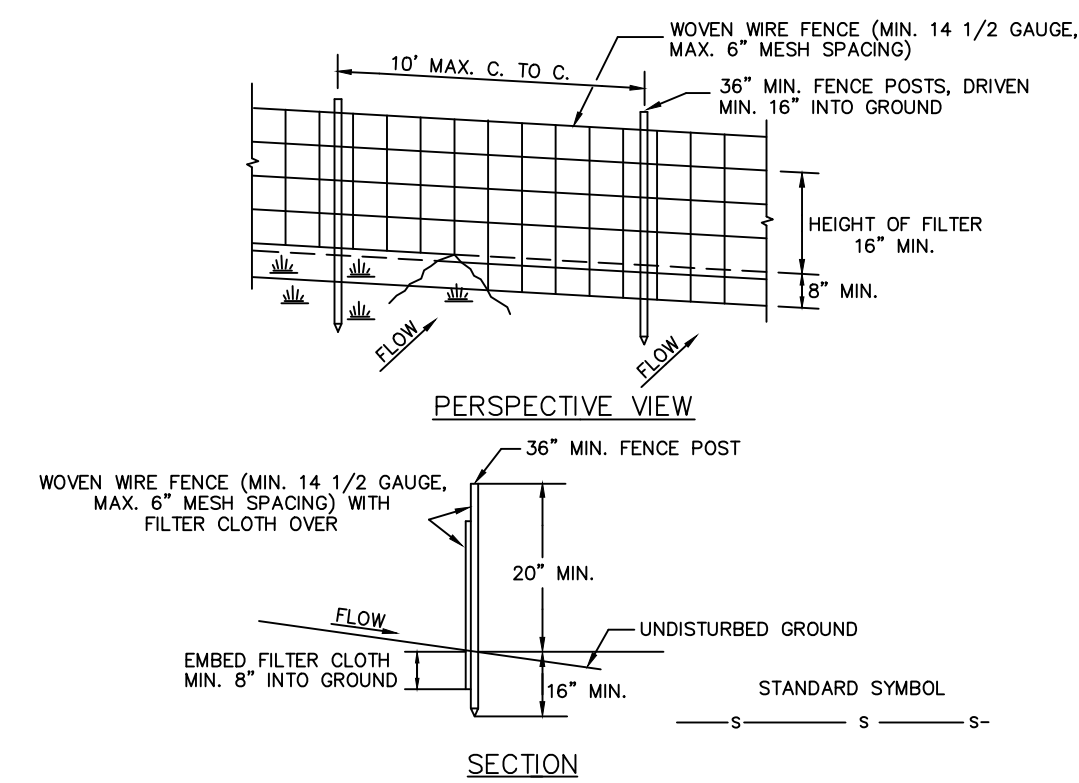

CONSTRUCTION NOTES FOR FABRICATED SILT FENCE

- WOVEN WIRE FENCE TO BE FASTENED SECURELY TO FENCE POST WITH WIRE TIES OR STAPLES.
 - FILTER CLOTH TO BE FASTENED SECURELY TO WOVEN WIRE FENCE WITH TIES SPACED EVERY 24" AT TOP AND MID SECTION.
 - WHEN TWO SECTIONS OF FILTER CLOTH ADJOIN EACH OTHER THEY SHALL BE OVERLAPPED BY 6" AND FOLDED.
 - MAINTENANCE SHALL BE PERFORMED AS NEEDED AND MATERIAL REMOVED WHEN "GULGES" DEVELOP IN THE SILT FENCE.
- POSTS: STEEL EITHER T OR U TYPE OR 2" HARDWOOD
FENCE: WOVEN WIRE, 14 1/2 GA. 6" MAX. MESH OPENING
FILTER CLOTH: FILTER X, MIRAFI 100X, STABILINKA T140N OR APPROVED EQUAL
PREFABRICATED UNIT: GEOPAB, ENVROFENCE, OR APPROVED EQUAL

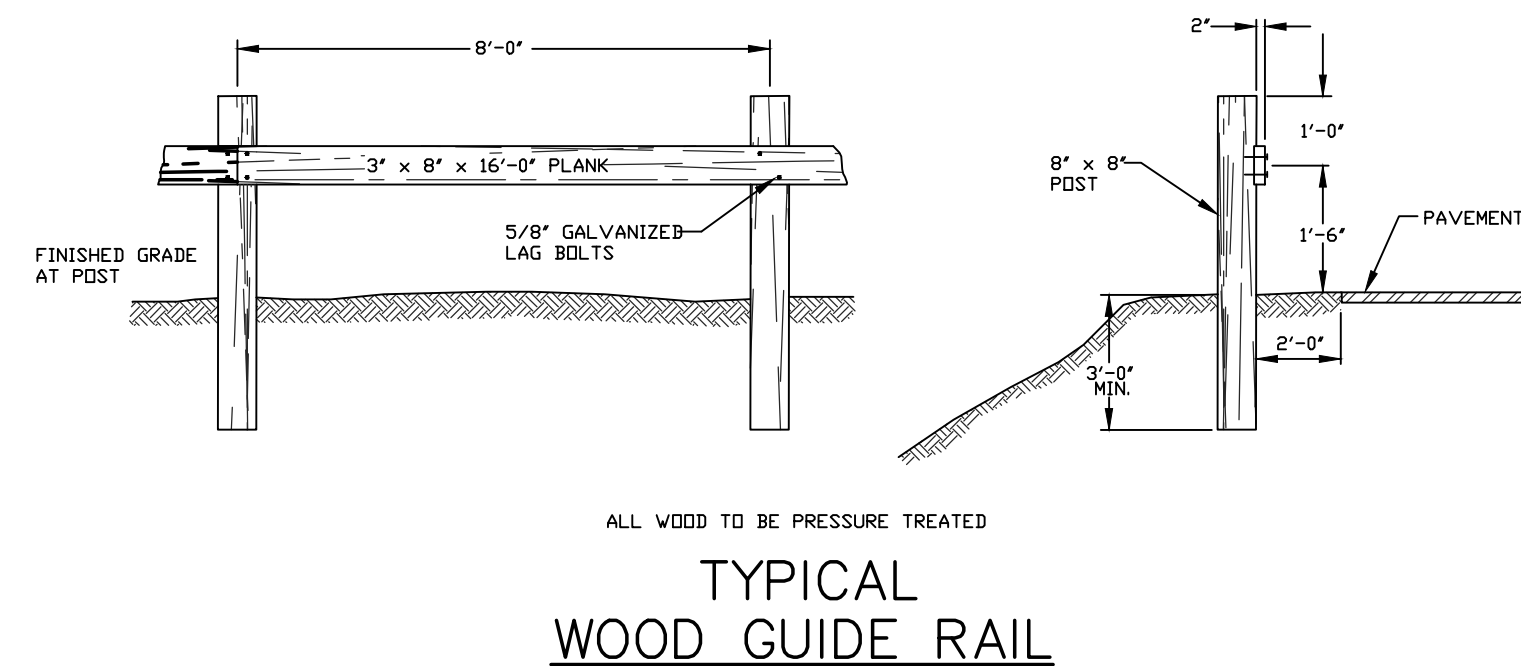

TYPICAL WOOD GUIDE RAIL

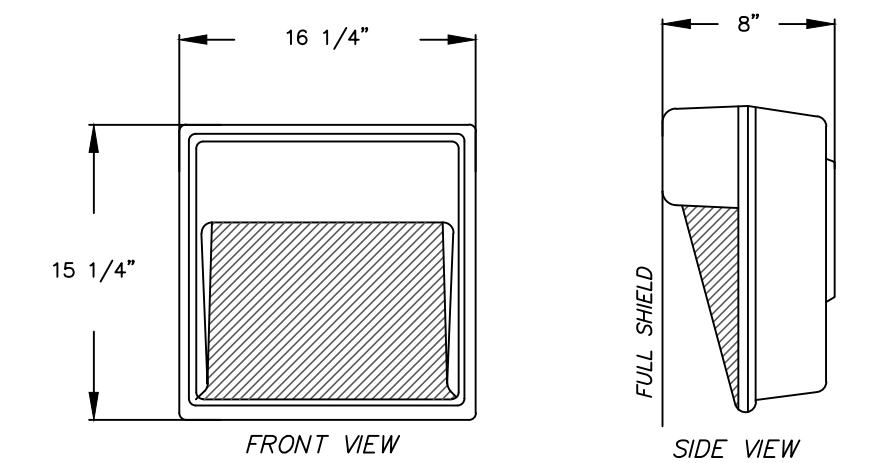

EXTERIOR WALL LIGHT DETAIL

WALL MOUNTED LIGHT SPECIFICATIONS

- LITHONIA LIGHTING - DIE CAST WALL PACK, GLASS REFRACTOR
TMH-100S
DISTRIBUTION - TYPE IV
LAMP - (HPS)
WATTS - 100
COLOR - DARK BRONZE
MOUNTING HEIGHT (FT.) - 12'
- LIGHT UNITS TO BE SUPPLIED WITH FULL SHIELD SO THAT NO OFF-SITE GLARE RESULTS.

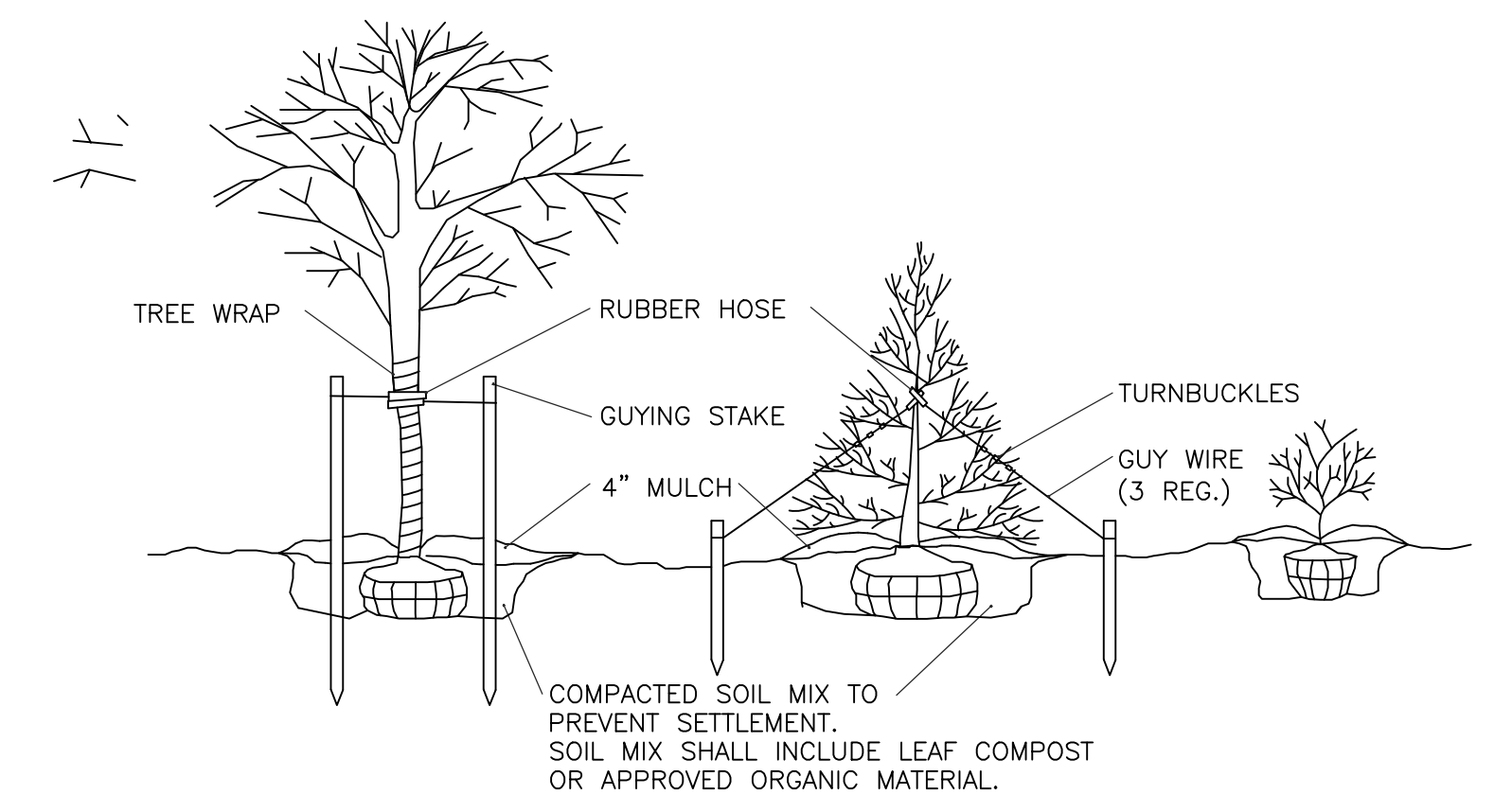

TYPICAL PLANTING & GUYING DETAIL

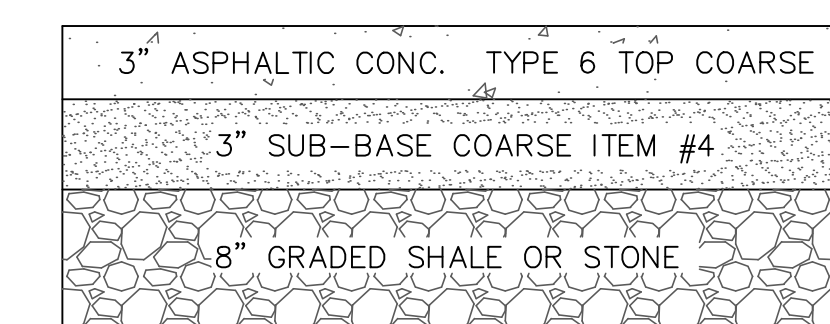

DRIVEWAY & PARKING LOT CROSS-SECTION

LIGHTING, LANDSCAPING AND DETAILS FOR

PROPOSED WORKSHOP

TOWN OF CHESTER
SCALE: 1" = 40'

ORANGE COUNTY, N.Y.
JANUARY 31, 2017
REVISED: MARCH 21, 2017
REVISED: APRIL 19, 2017

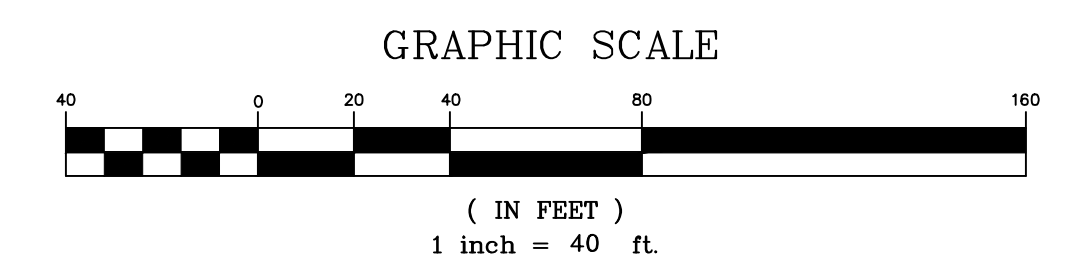

TOWN OF CHESTER
APPROVAL BOX