

- o Contractor shall be responsible for the removal and replacement of signs, guide rails, guide posts, culvert pipes, mailboxes, headwalls, etc. which must be removed for construction. Contractor shall reinstall any removed items on a daily basis. Any items damaged by removal or reinstallation shall be replaced and reinstalled by the contractor with a new item.
- o All work on the Water, Sewer Storm Drainage) is allowed to be performed between November 15 and March 15 within the County Right of Way.
- o No track equipment is allowed on the County Road without placing mats, plywood, tires, etc. to protect the asphalt road.
- o No open trenches are allowed to remain open overnight.
- o All open trenches are required to be backfilled on a daily basis.
- o All disturbed areas for the installation of the driveways are required to be shaped and graded, seeded and mulched (within 24 hours) of completion of the stabilized entrance.

- Any planting and landscaping features are required to be offset from the property line by 4 feet.

- Provide Cross Section Details for Backfill Requirements within the Asphalt, Within 8 feet of the Edge of Pavement, and 8 feet beyond from the Edge of Pavement.
- Dry K Crete shall be used at all road crossing (town roads), commercial entrances, and all trenches within Asphalt or as directed by Orange County Inspector.
- Item No. 4, Item 304.12 Subbase Course Type 2 is required to be used as backfill from edge of pavement out eight feet.
- Excavated material is allowed to be used as backfill material 8 ft beyond the edge of pavement. No boulders/rocks over 12 inches are allowed to be used as backfill.
- Material tickets are required to be provided to the Orange County Inspector on a daily basis for all material used in the County Right of Way.

- All pavement restoration needs to be completed on a daily basis.
- Ragged trench edges must saw cut prior to any paving (temporary or permanent).
- It will be the responsibility of the contractor to maintain the 5" binder course flush with the existing pavement surface throughout the duration of the project. Final asphalt restoration is to be completed at the completion of the project.
- All temporary asphalt is required to be five (5) inches thick and placed in two (2) lifts of 2 1/2 inches.
- All edges of existing asphalt are required to be swept and tack coated prior to paving.
- All Asphalt is required to be saw cut parallel or perpendicular to the trench or to the existing asphalt. No ragged edges are accepted.
- All saw cutting is required to be performed prior to placing Asphalt Binder. Milling out the jagged edges on the top course or final asphalt will not be accepted by Orange County.
- All Asphalt joints are required to be cracked and sealed from completing final paving.

- Provide notes that all work is to be performed in accordance with Orange County Requirements.  
The following signs are required to be placed in each direction to perform the work per the approved plans: Road Work 1500 Ft, Road Work 1000 Ft, Road Work 500 Ft, One Lane Road

- Ahead, Flagger Symbol on each approach when taking a travel lane. When work is performed on the shoulder the following signs are required: Road Work 1500 Ft, Road Work 1000 Ft, Road Work 500 Ft. No Shoulder. Flagger Symbols are required to be available for a "No Shoulder" Work Zone in case flaggers are used to direct traffic.
- All Work Zones and Projects must have a flagger stationed at the installed and in place prior to any work starting. All construction signage is required to meet the requirements as per the "National Manual of Uniform Traffic Control Devices for Streets and Highways" and NYS Supplement latest edition and revisions. In a case where County requirements are more stringent with regard required MUTP signage, the County requirements are the standard to be adhered to.
  - The construction signage is required to be installed on permanent posts on the roadway posts or on solid-master and covered and uncovered on a daily basis. The contractor must have all the necessary construction signs to perform the work safely; i.e. Additional signage: One Lane Road Ahead, Flagger Symbol, if a lane has to be closed to perform work.
  - All construction signage is required to be **730-05.02 - ASTM Type III (Class B)** as per NYS Standard Specifications: Construction Signs and Materials. Hi-intensity reflective sheeting
  - often referred to as high intensity. It is recommended for highway signs, construction signs, delineators, and other work zone devices.
  - Work zone is required to be properly delineated with cones or construction barrels.
  - Orange County reserves the right to preclude all work and lane closures during any inclement weather or other unforeseen circumstances (i.e. wet, icy conditions, reduced visibility, traffic accidents on state, county, town or village road, or other emergencies).
  - No lanes closures will be permitted from 12 noon prior to a holiday and until 10 am the day after the holiday.
  - Flaggers shall not control more than one approach at any time throughout the duration of the work zone. Additional flaggers are required to control all approaches in a work zone.
  - Eighteen (18) inch stop and slow paddles are required to direct traffic.
  - Two way radios are required for flaggers to communicate between each other.

|                       | <u>MINIMUM REQUIRED</u> | <u>PROVIDED</u> |
|-----------------------|-------------------------|-----------------|
| LOT AREA (AC.)        | 2                       | 2.012           |
| LOT WIDTH (FT.)       | 200                     | 460±            |
| FRONT YARD (FT.)      | 75                      | 95±             |
| REAR YARD (FT.)       | 50                      | 50±             |
| SIDE YARD (FT.)       | 20                      | 21±             |
| BOTH SIDE YARDS (FT.) | 40                      | 90±             |

|                       | <u>MAXIMUM ALLOWED</u> |     |
|-----------------------|------------------------|-----|
| BUILDING HEIGHT (FT.) | 40                     | <40 |
| BUILDING COVERAGE (%) | 30                     | 6±  |

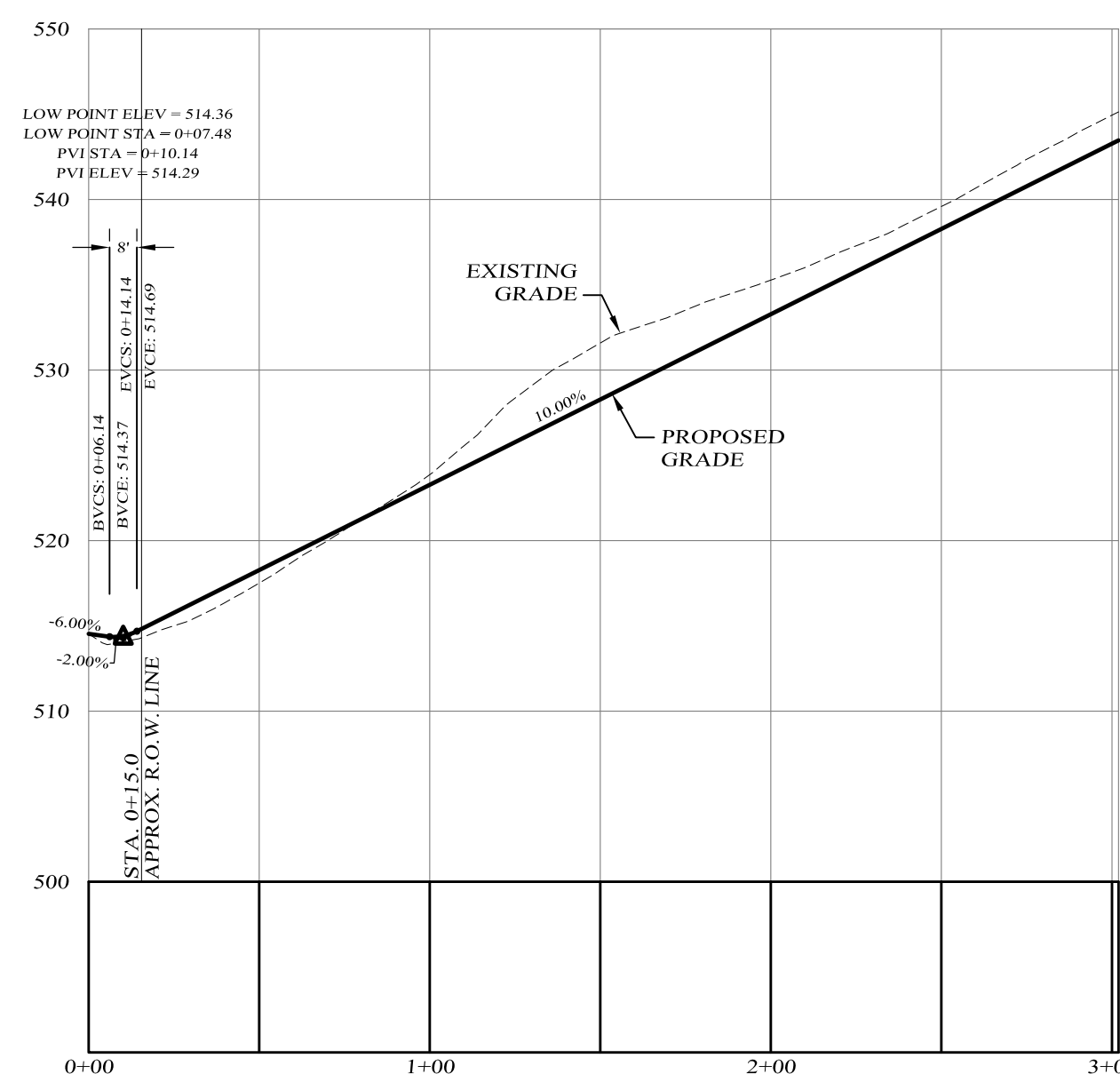

VER: 1" = 10'  
HOR: 1" = 50'

1. TOWN OF CHESTER TAX PARCEL SEC. 6, BLK. 1, LOT 68.2
2. TOTAL AREA OF THIS PARCEL PER SURVEY = 2,012 AC.
3. PARCEL LIES WITHIN THE GC ZONING DISTRICT.
4. TOPOGRAPHIC AND BOUNDARY INFORMATION FROM MAP ENTITLED "SITE PLAN FOR DEPAULIS & SONS INC." PREPARED BY: JAMES A. DILLIN, PLS., GOSHEN, VT.
5. THERE ARE NO WELL OR SEPTIC FACILITIES PROPOSED.
6. ALL TREE CUTTING SHALL BE LIMITED TO BETWEEN NOVEMBER 1 THROUGH MARCH 31.
7. SHALL ANY PROPERTY ADJOINERS HAVE OBJECTIONS TO THE LIGHT POLLUTION OR EXCESSIVE MOUNTED LIGHTS, THE BUILDING INSPECTOR SHALL HAVE THE RIGHT TO REQUEST ADJUSTMENT OR ALTERATION.

|                |                |                        |         |      |  |
|----------------|----------------|------------------------|---------|------|--|
| OTHER, P.E.    |                | N.Y.S. LIC. NO. 079053 |         | DATE |  |
| D.O.T. SHEET # | D.E.C. SHEET # | O.C.H.D. SHEET #       | SHEET # |      |  |
| N.A.           | N.A.           | N.A.                   | 1 OF    |      |  |
| CAD #          | PROJECT #      | SCALE                  |         |      |  |
| 21117 CONC     | 21117          | AS SHOWN               |         |      |  |

EXISTING PROPERTY LINE  
EXISTING 10' CONTOUR LINE  
EXISTING 2' CONTOUR LINE  
EXISTING EDGE OF PAVEMENT  
BUILDING SETBACK LINE  
PROPOSED CONTOUR LINE  
(500)  
PROPOSED CHAIN LINK FENCE  
PROPOSED LIMIT OF DISTURBANCE  
PROPOSED SILT FENCE  
PROPOSED SWALE  
EXISTING TREE LINE

|             |                   |
|-------------|-------------------|
| MON. - FRI. | 7:00 AM - 6:00PM  |
| SAT.        | 8:00 AM - 12:00PM |

MAXIMUM LIGHTING HEIGHT =  
= (DISTANCE FROM LIGHT TO PROPERTY LINE / 3) + 3 FEET.  
= (45 FEET / 3) + 3 FEET.  
= 15 FEET + 3 FEET.  
= 18 FEET

MAXIMUM LIGHTING HEIGHT = 18 FEET  
PROPOSED LIGHTING HEIGHT = 15 FEET

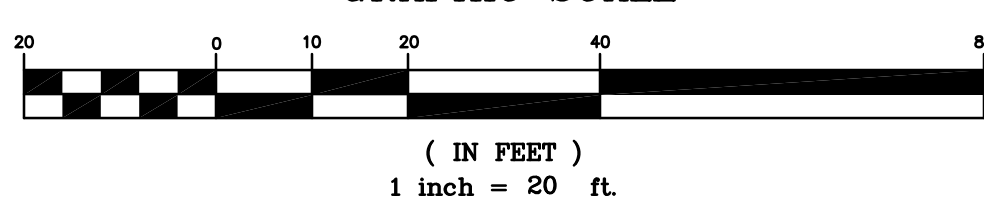

SHEET #1 - iCAN STORAGE SITE PLAN  
SHEET #2 - DETAIL SHEET

David & Judy Klein  
135 North Route 9W  
Congers, NY 10920

|   |                                     |
|---|-------------------------------------|
|   |                                     |
|   |                                     |
| 12-20-21  | ADD TREE CUTTING NOTE & SIGN DETAIL |
| 10-26-21  | REV PER ENGINEER'S COMMENTS         |
| 09-15-21  | INITIAL PREPARATION                 |
| DATE  | REVISIONS                           |
| UNAUTHORIZED ALTERATIONS OR ADDITIONS TO A DOCUMENT BEARING A LICENSED PROFESSIONAL ENGINEER IS A VIOLATION OF SECTION 2 OF THE NEW YORK STATE EDUCATION LAW. REPRODUCTIONS OF DO NOT BEAR THE ORIGINAL SEAL OF A LICENSED PROFESSIONAL. BE CONSIDERED INVALID. |                                     |