

CONSTRUCTION SPECIFICATIONS:

NOTE:
ENTRANCE SHALL BE MAINTAINED AS CONDITIONS DEMAND TO PREVENT TRACKING OF SEDIMENT ONTO PUBLIC R.O.W.
ALL SEDIMENTATION STRUCTURES WILL BE INSPECTED AND MAINTAINED ON A REGULAR BASIS.
A CRUSHED STONE, VEHICLE WHEEL-CLEANING BLANKET WILL BE INSTALLED WHENEVER A CONSTRUCTION ACCESS ROAD INTERSECTS ANY PAVED ROADWAY. SAID BLANKET WILL BE COMPOSED OF 6" DEPTH OF 1"-1-1/2" CRUSHED STONE. WILL BE AT LEAST 12' x 50' AND SHOULD BE PLACED ON COMPACTED SUB-GRADE AND SHALL BE MAINTAINED.
ALL DRIVEWAYS MUST BE STABILIZED WITH 1"-1-1/2" CRUSHED STONE OR SUB-BASE PRIOR TO INDIVIDUAL HOME CONSTRUCTION.
THE ROAD MUST BE CLEANED DAILY, OR AS REQUIRED BY O.C.D.P.W., WITH A MECHANICAL SWEEPER.
PAVED ROADWAYS MUST BE KEPT CLEAN AT ALL TIMES.
ALL CATCH BASIN INLETS WILL BE PROTECTED WITH A CRUSHED STONE OR HAYBALE FILTER (FILTER DETAILS APPEAR ON PLAN).
ALL STORM DRAINAGE OUTLETS WILL BE STABILIZED, AS REQUIRED, BEFORE DISCHARGE POINTS BECOME OPERATIONAL.
ALL SOIL EROSION AND SEDIMENT CONTROL STRUCTURES MUST BE DETAILED ON THE PLAN. SEE SECTION VII. (SOIL EROSION SEDIMENT CONTROL), PAGE 14.

COUNTY ROAD R.O.W.

STABILIZED CONSTRUCTION ENTRANCE DETAIL

NOT TO SCALE

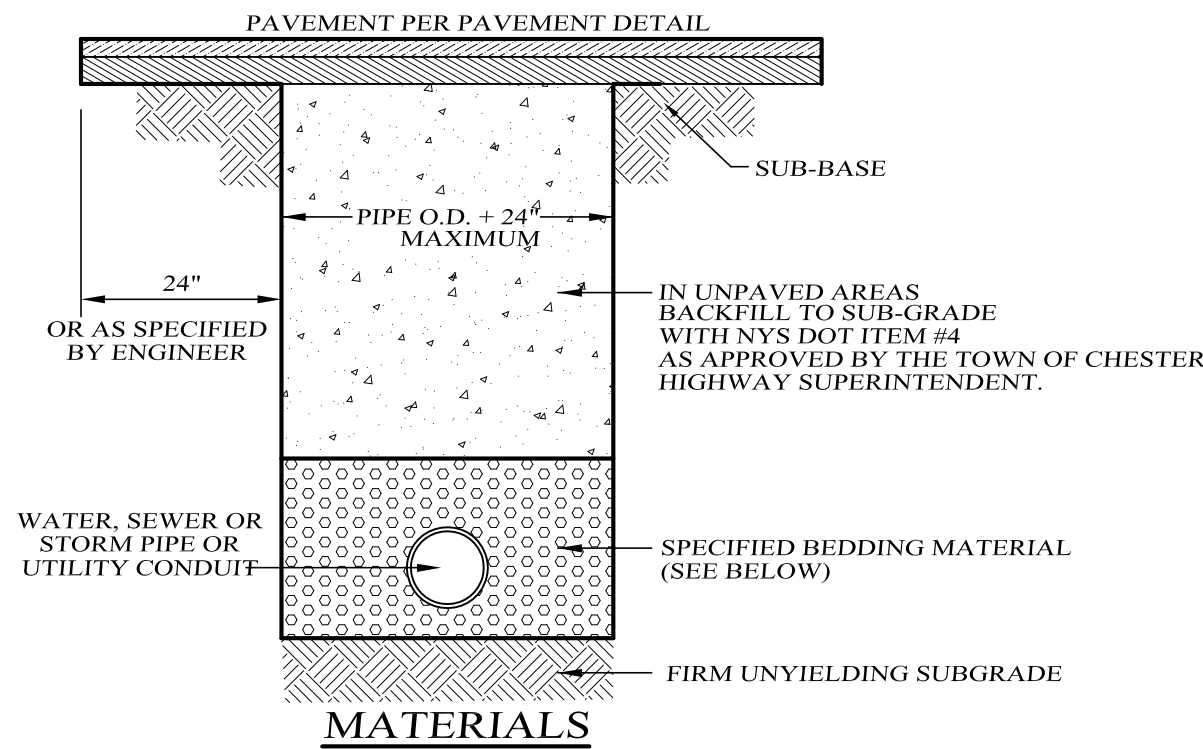

PIPE ZONE BEDDING MATERIAL:
1. WATER MAINS: SAND OR RUN-OF-BANK GRAVEL, AS APPROVED BY SOILS ENGINEER.
2. SEWER MAINS: 1/4" CRUSHED STONE.
3. STORM SEWER: 1/4" CRUSHED STONE.

PIPE ZONE BACKFILL MATERIAL:
1. WATER MAINS: ON-SITE MATERIAL FREE OF STONE, CLAY FOREIGN MATERIAL OR FROZEN EARTH AS APPROVED BY SOILS ENGINEER.
2. SEWER MAINS: 1/4" CRUSHED STONE.
3. STORM SEWER: ON-SITE MATERIAL FREE OF STONE, CLAY FOREIGN MATERIAL OR FROZEN EARTH AS APPROVED BY SOILS ENGINEER.

PIPE BEDDING AND BACKFILL

DETAIL

NOT TO SCALE

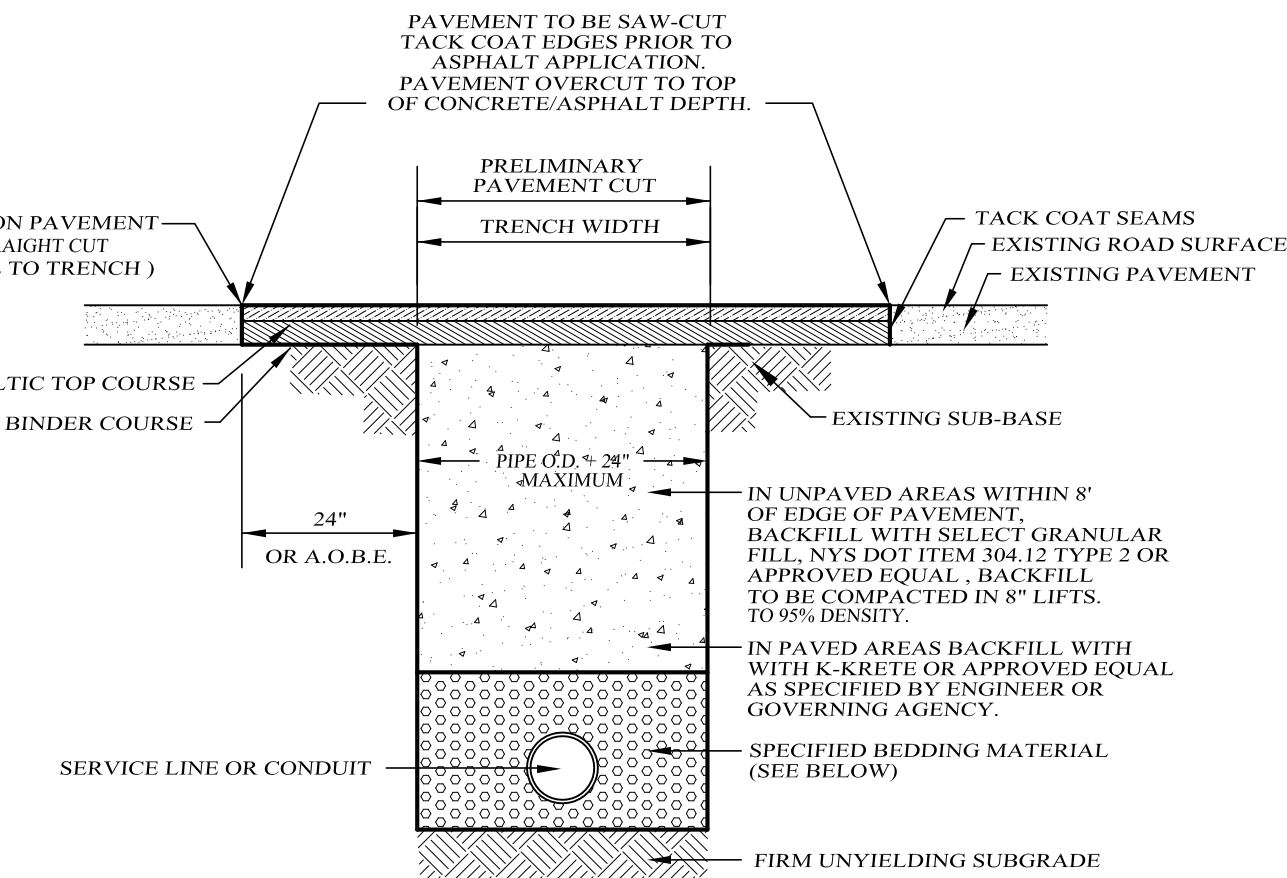

PIPE ZONE BEDDING MATERIAL:
1. WATER MAINS: SAND OR RUN-OF-BANK GRAVEL, AS APPROVED BY SOILS ENGINEER.
2. SEWER MAINS: 1/4" CRUSHED STONE.
3. STORM SEWER: 1/4" CRUSHED STONE.

PIPE ZONE BACKFILL MATERIAL:
1. WATER MAINS: ON-SITE MATERIAL FREE OF STONE, CLAY FOREIGN MATERIAL OR FROZEN EARTH AS APPROVED BY SOILS ENGINEER.
2. SEWER MAINS: 1/4" CRUSHED STONE.
3. STORM SEWER: ON-SITE MATERIAL FREE OF STONE, CLAY FOREIGN MATERIAL OR FROZEN EARTH AS APPROVED BY SOILS ENGINEER.

PIPE BEDDING AND BACKFILL DETAIL

WITHIN COUNTY ROAD R.O.W.

NOT TO SCALE

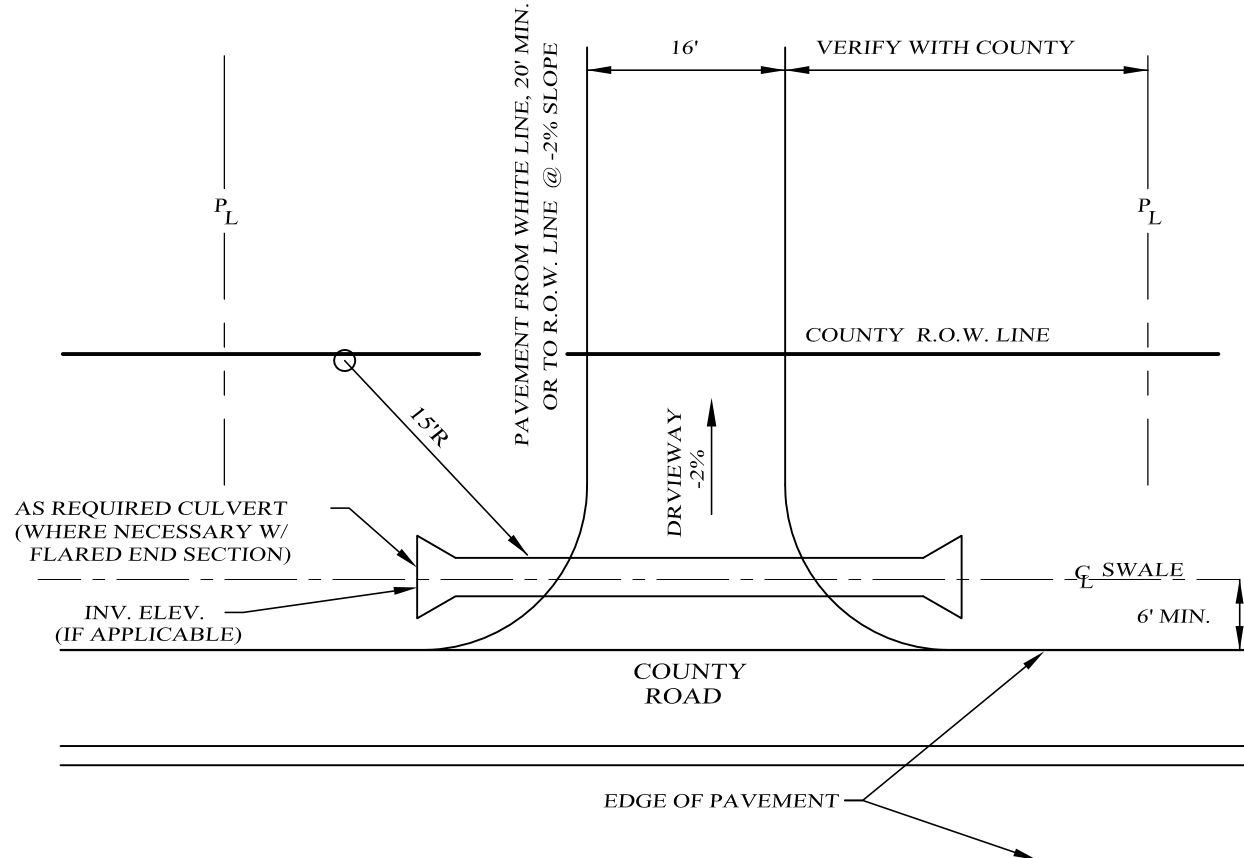

- NOTES:
- WHERE DEEMED NECESSARY BY O.C.D.P.W. OR MUNICIPAL REQUIREMENTS CONCRETE CURBING CHANNELIZATION WILL BE PROVIDED AS SPECIFIED.
 - IF H.D.P.E. CULVERT, THEN 12" MINIMUM COVER REQUIRED AS PER MANUFACTURER'S SPECIFICATIONS TO BE ACCEPTED BY O.C.D.P.W. IF 12" MIN. COVER CANNOT BE OBTAINED, 1/4" STEEL CASING PIPE SHOULD BE USED.
 - AT THE TIME OF CONSTRUCTION, THE NEW DRIVEWAY PAVEMENT IS TO BE KEYS INTO THE COUNTY ROAD SHOULDER ASPHALT AS DIRECTED BY THE ORANGE COUNTY DEPARTMENT OF PUBLIC WORKS - DIVISION OF ENGINEERING.
 - DRIVEWAY TO MEET THE COUNTY PAVEMENT STANDARDS FOR A MINIMUM OF 20 FEET FROM THE WHITE LINE.
 - BEYOND FIRST 20 FEET FOLLOW STANDARD DRIVEWAY DETAIL FOR BASE AND PAVEMENT REQUIREMENTS.
 - ALL DRIVEWAYS MUST BE STABILIZED (12" W X 50' D MIN.) X 12" THICK WITH 1"-1-1/2" CRUSHED STONE OR SUB-BASE PRIOR TO INDIVIDUAL HOME CONSTRUCTION.
 - THE ROAD MUST BE CLEANED DAILY, OR AS REQUIRED BY O.C.D.P.W. WITH A MECHANICAL SWEEPER.

TYPE OF ENTRANCE	WIDTH (W)	RADIUS (R)
RESIDENTIAL	10'-16'	15'-20'
COMMERCIAL DRIVE	12' PER LANE	30'-40'
PUBLIC HIGHWAY	11'-12' PER LANE	30'-40'

DRIVEWAY OR ROAD CONNECTION DETAIL

WITHIN COUNTY ROAD R.O.W.

NOT TO SCALE

GENERAL NOTES:

- EXISTING UTILITY INFORMATION SHOWN HEREON HAS BEEN COLLECTED FROM VARIOUS SOURCES AND IS NOT GUARANTEED AS TO ACCURACY OR COMPLETENESS. THE CONTRACTOR SHALL VERIFY ALL INFORMATION TO HIS SATISFACTION PRIOR TO EXCAVATION. THE CONTRACTOR SHALL NOTIFY THE UNDER SIGNED PROFESSIONAL IMMEDIATELY IF ANY FIELD CONDITIONS ENCOUNTERED DIFFER MATERIALLY FROM THOSE REPRESENTED HEREON. SUCH CONDITIONS COULD RENDER THE DESIGNS HEREON INAPPROPRIATE OR INEFFECTIVE.
 - THIS SET OF PLANS HAS BEEN PREPARED FOR THE PURPOSES OF MUNICIPAL AND AGENCY REVIEW AND APPROVAL. THIS SET OF PLANS SHALL NOT BE UTILIZED AS CONSTRUCTION DOCUMENTS UNTIL ALL APPROVALS REQUIRED HAVE BEEN OBTAINED. ALL CONDITIONS OF APPROVAL HAVE BEEN SATISFIED AND THE DRAWINGS HAVE BEEN STAMPED "ISSUED FOR CONSTRUCTION". THIS SET OF PLANS INCLUDES APPROVAL OF ALL CATALOG CUTS, SHOP DRAWINGS AND/OR DESIGN CALCULATIONS AS REQUIRED BY THE PROJECT OWNER AND/OR MUNICIPALITY.
- #### ORANGE COUNTY DEPARTMENT OF PUBLIC WORKS NOTES:
- NO SITE PREPARATION OR CONSTRUCTION, INCLUDING UTILITY CONNECTIONS, SHALL COMMENCE UNTIL A VALID HIGHWAY WORK PERMIT HAS BEEN SECURED FROM THE ORANGE COUNTY DEPARTMENT OF PUBLIC WORKS UNDER SECTION 136 OF THE HIGHWAY LAW.
 - THE VEGETATIVE DRIP EDGE, AT MATURITY, SHALL NOT PROJECT INTO THE COUNTY R.O.W.
 - NO SIGNS SHALL BE PLACED WITHIN, OR PROJECT INTO, THE COUNTY R.O.W.

THIS SHEET SHALL BE CONSIDERED INCOMPLETE AND INVALID UNLESS ACCOMPANIED BY SHEETS NUMBER 1 THRU 3 IN THE SET OF 3.

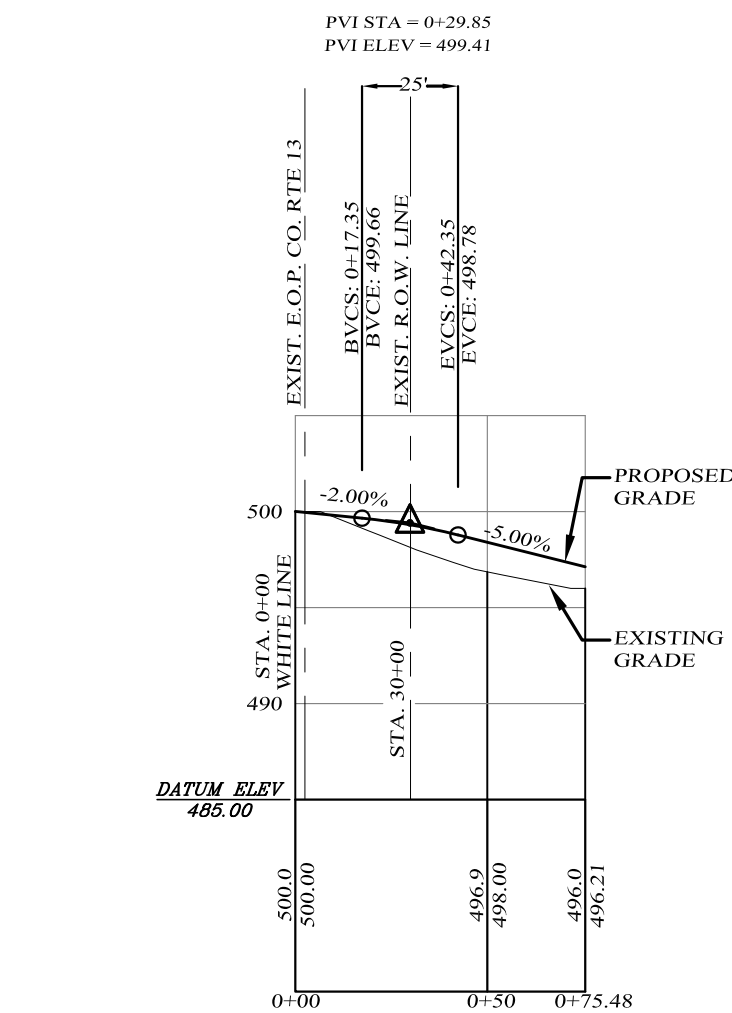

PROPOSED DRIVEWAY PROFILE

SCALES: HOR: 1" = 50'
VER: 1" = 10'

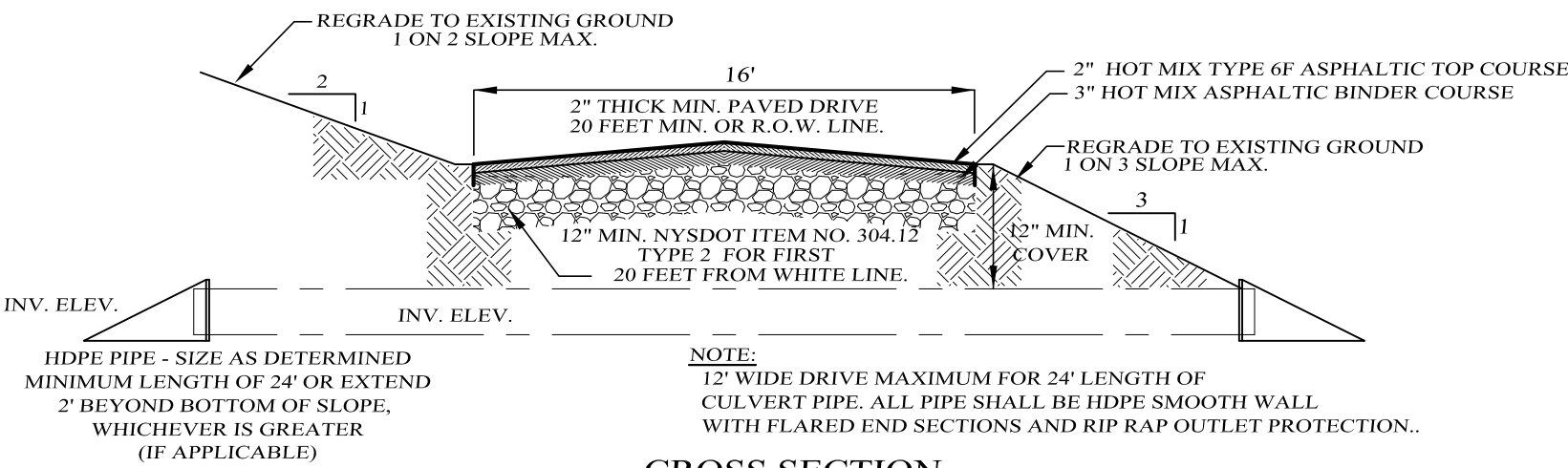

RESIDENTIAL DRIVEWAY DETAIL

WITHIN COUNTY ROAD R.O.W.

NOT TO SCALE

- NOTES:
- EXISTING SWALES ALONG THE COUNTY ROAD TO BE GRADED TO ENSURE POSITIVE DRAINAGE.
 - THE EDGE OF THE NEW ASPHALT APRON IS REQUIRED TO BE BACKED UP WITH ITEM NO. 4 AND TAPERED INTO THE EXISTING GRADES.
 - ALL DISTURBED AREAS ARE REQUIRED TO BE PROPERLY GRADED, SEED & STRAWED OR OTHERWISE STABILIZED, UPON INSTALLATIONS ON THE CULVERT PIPE.
 - NO STONES / BOULDERS ALLOWED TO BE USED AT HEADWALLS.
 - NO PAVERS ALLOWED WITHIN COUNTY R.O.W.
 - NEW GUTTERS / SWALES SHALL BE GRADED TO EXISTING ROAD SWALES AND / OR DRIVEWAY CULVERTS TO MAINTAIN POSITIVE DRAINAGE FLOWS AND PREVENT FLOODING OF ROADWAYS.

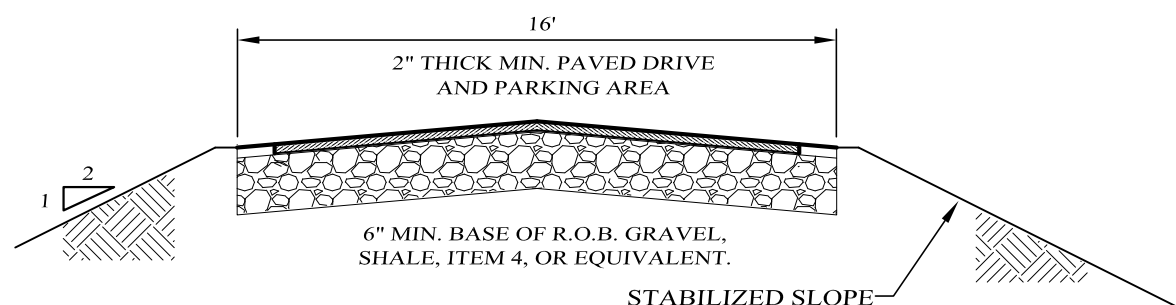

RESIDENTIAL DRIVEWAY/PARKING DETAIL

(WITHIN SITE)

NOT TO SCALE

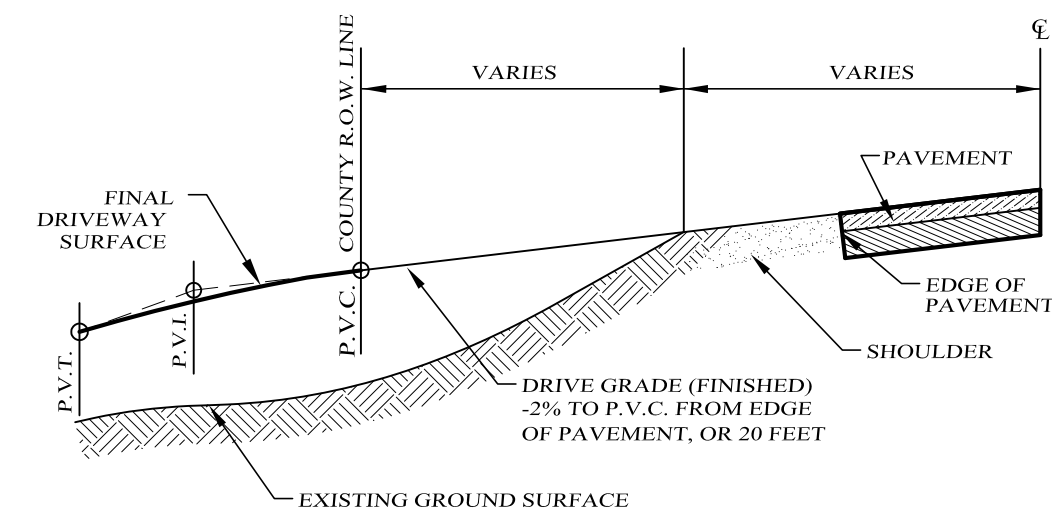

TYPICAL CROSS SECTION: FILL

WITHIN COUNTY ROAD R.O.W.

NOT TO SCALE

NOTE:
DRIVEWAY SHALL BE PAVED FROM EDGE OF PAVEMENT TO COUNTY R.O.W. LINE, OR 20' MINIMUM, AS DIRECTED BY ORANGE COUNTY DEPT. OF PUBLIC WORKS DIVISION OF ENGINEERING. SAW CUT AS REQUIRED TO PROVIDE A CLEAN, STRAIGHT EDGE, TACK COAT EDGE OF PAVEMENT PRIOR TO NEW ASPHALT INSTALLATION.

NOTE

CONTACT UNDERGROUND FACILITIES PROTECTION ORGANIZATION 3 DAYS PRIOR TO CONSTRUCTION @ "DIG SAFELY N.Y. 800-962-7962".

10-08-20	REV. ADD COUNTY ENTRANCE DETAILS
09-29-20	REV. PLANNING BOARD SUBMITTAL
03-03-20	INITIAL PREPARATION
DATE	REVISIONS
KIRK ROTHER, P.E.	N.Y.S. LIC. NO. 079033
D.O.T. SHEET #	D.E.C.S. SHEET #
O.C.H.D. SHEET #	SHEET #
N.A.	N.A.
CAD # 20104	PROJECT #
10-08-2020	20104
SCALE	AS SHOWN
3 OF 3	