

SCOPE OF WORK

TO INSTALL A SOLAR PHOTOVOLTAIC (PV) SYSTEM AT THE TOLIS RESIDENCE, LOCATED AT 70 RALPHIE LANE IN CHESTER, NY. THE POWER GENERATED BY THE PV SYSTEM WILL BE INTERCONNECTED WITH THE UTILITY GRID THROUGH THE EXISTING ELECTRICAL SERVICE EQUIPMENT.  
THE PV SYSTEM DOES NOT INCLUDE STORAGE BATTERIES.

SYSTEM RATING

15 kW stc DC

EQUIPMENT SUMMARY

- 45 Sunpower/X21-335 PV MODULES
- 1 SolarEdge SE11400-US PV INVERTER(S)

SHEET INDEX

- PV-1 COVER/SITE MAP
- PV-2 ELECTRICAL 3-LINE DIAGRAM
- PV-3 SYSTEM LABELING DETAIL

GOVERNING CODES

- 2008 NATIONAL ELECTRICAL CODE
- 2010 RESIDENTIAL BUILDING CODE OF NEW YORK STATE
- UNDERWRITERS LABORATORIES (UL) STANDARDS
- OSHA 29 CFR 1910.269

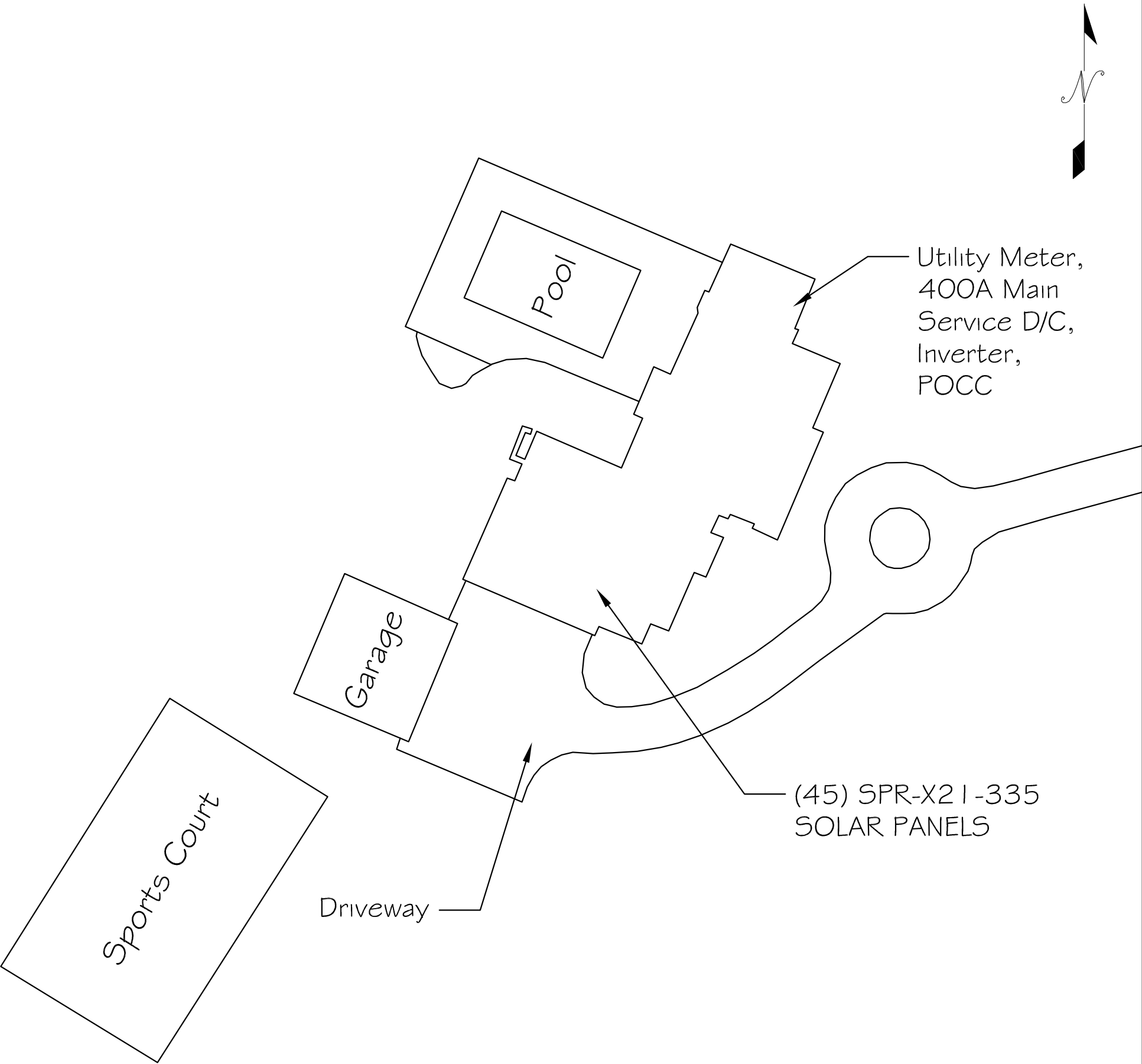

DESIGN & DRAFTING BY:  
Bryan McGum  
NABCEP Certified  
#PV-101913-Q02446

REVISIONS		
DESCRIPTION	DATE	REV
ORIGINAL	01/27/2016	A
CHANGE ORDER	03/14/2016	B

CONTRACTOR



LIGHTHOUSE SOLAR  
4 CHERRY HILL RD  
NEW PALTZ, NY, 12561

PROJECT NAME

Arthur Tolis  
70 Ralphie Lane  
Chester, NY 10918

SHEET NAME

COVER/SITE  
MAP

SHEET SIZE

ANSI B  
11"x17"

SHEET NUMBER

PV-1